

Pavilion Sheet – BS5

General information	
Purpose of the facility	Pavilion for participating countries
Type of pavilion	Pavilion Module (Type B)
Exhibition Space number	BS5
Exhibition Space area size	291.24 m ²
Building structure	Steel frame
Maximum height of exhibit (height between floor slab and the bottom of beam)	6.65 m
Floor level	Ground floor
Structural load capacity	Floor load capacity: 9.8 kN/m ² Ceiling suspension load capacity: 200 N/m ² Load capacity of eaves support: 50 kg/m Load capacity of facade base material: 30 kg/m ²

Utility infrastructure of the assigned Exhibition Space (maximum capacity)

Service water supply	8 m ³ /day
Electric power supply	1Φ : 20kVA 3Φ : 40kVA
Heat supply	52 kW
Telecommunication capacity	Depends on the participant's contract with a telecommunication operator
Gas supply	Depends on the participant's contract with an LPG supplier (gas is supplied in containers such as gas cylinders).

Location of the Pavilion

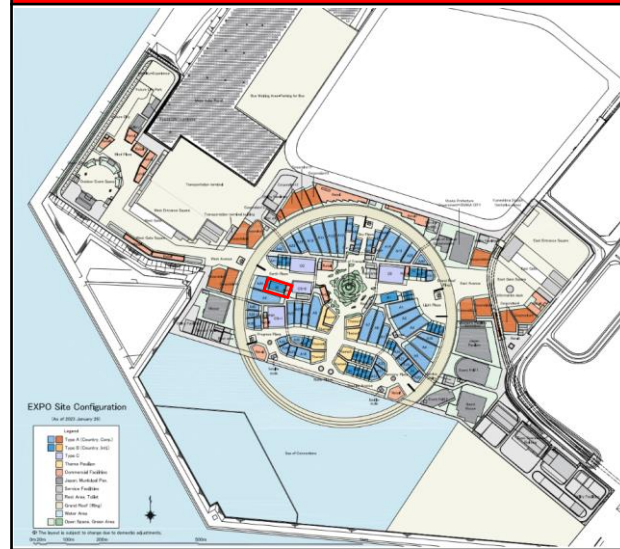



Notes on design

1. For designs, refer to the Design Guidelines for Pavilion Modules (Type B).
2. The supply capacities and dimensions are subject to change until they are finalised following the Organiser's final coordination. The dimensions are given in metrics.
3. Height is above ground level (GL).
4. The details of Exhibition Spaces and infrastructure facilities are subject to minor modifications according to the Site Plan.
5. Participants shall comply with relevant Japanese laws as well as prefectural and municipal ordinances of Osaka when developing their designs.
6. Consult applicable schematic drawings provided by the Organiser for detail.

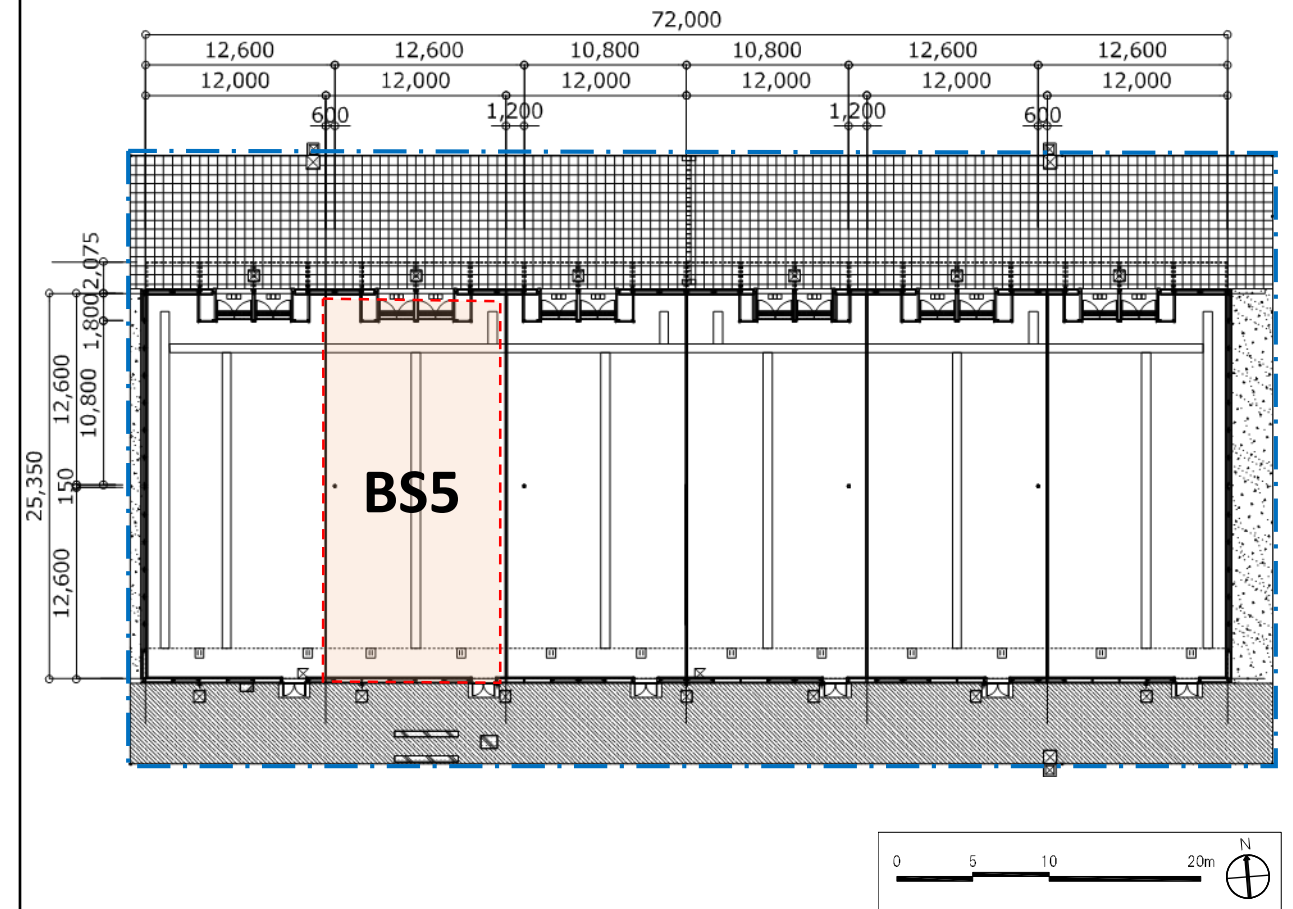
The Pavilion and Exhibition Spaces Layout Arrangements (Ground Plan)



Legend

- Pavilion site boundary
 Boundary of assigned Exhibition Space
 Assigned Exhibition Space

